

Adam, Rouilly

SERVING MEDICAL EDUCATION WORLDWIDE

AR253/AR253-B SKIN AND VEIN KIT

Instruction Manual



Thank you for purchasing this AR253/AR253-B Skin and Vein Kit for our AR251/AR251-B Venepuncture and Infusion Arm.

Please read this instruction manual carefully and retain it for future reference.

Safety and Precautions



The veins in this arm contain natural latex which may cause an allergic reaction to some individuals. If a reaction occurs, discontinue use immediately and seek medical advice.



Do not mark the skin with ink from ball point pens, marking pens or newsprint as these cannot be removed.



Lubricant supplied contains a dilute solution of bactericidal detergent and water (50 ml)

Causes skin irritation

Causes serious eye damage

Wear eye protection

Wear protective gloves

Wash hands thoroughly after handling



IF IN EYES: rinse cautiously with water for several minutes. Remove contact lenses if present and easy to do so.

If eye irritation persists: get medical advice/attention.

IF ON SKIN: wash with plenty of soap and water.

If skin irritation occurs: get medical advice/attention.

Contents

Parts	3
Replacing the Skin and Veins	
- Remove the Old Skin	5
- Identify Your Arm Core	5
Vein Kit Installation for Cores with Fingers	7
Vein Kit Installation for Cores with One Vein Loop	9
Vein Kit Installation for Cores with Two Vein Loops	11
Installing the New Skin	15

Parts

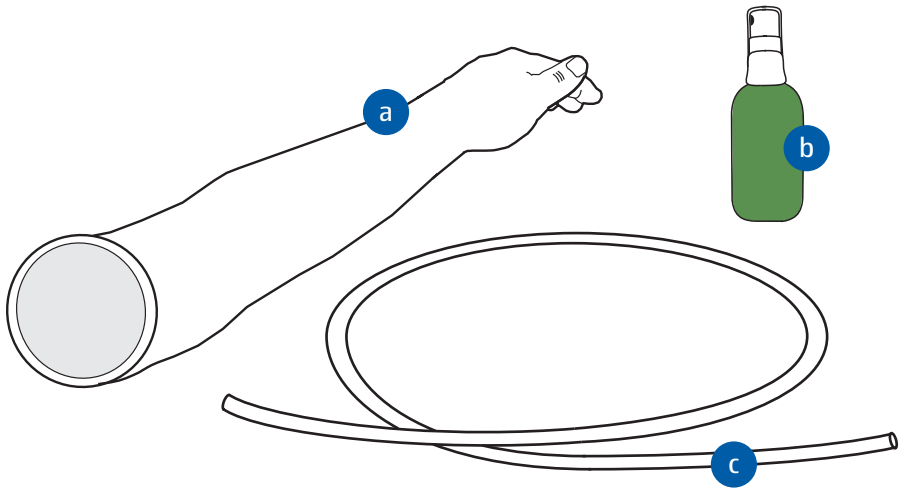

- a** Arm skin
- b** Lubricant spray
- c** Latex vein



Scan the QR code to access the product video.
<https://youtu.be/or1dsIFGunA>



Replacing the Skin and Veins

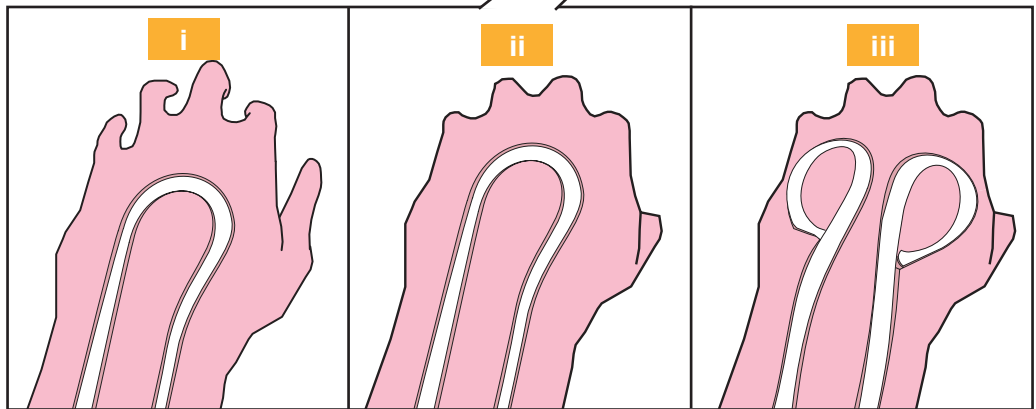
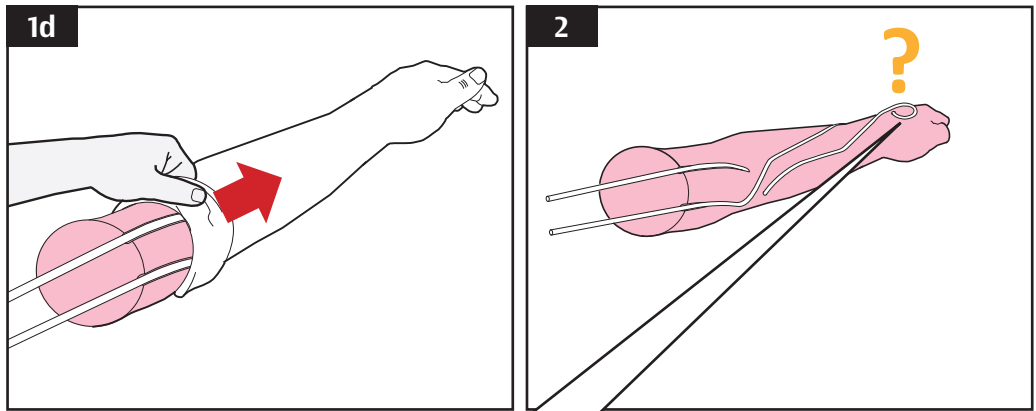
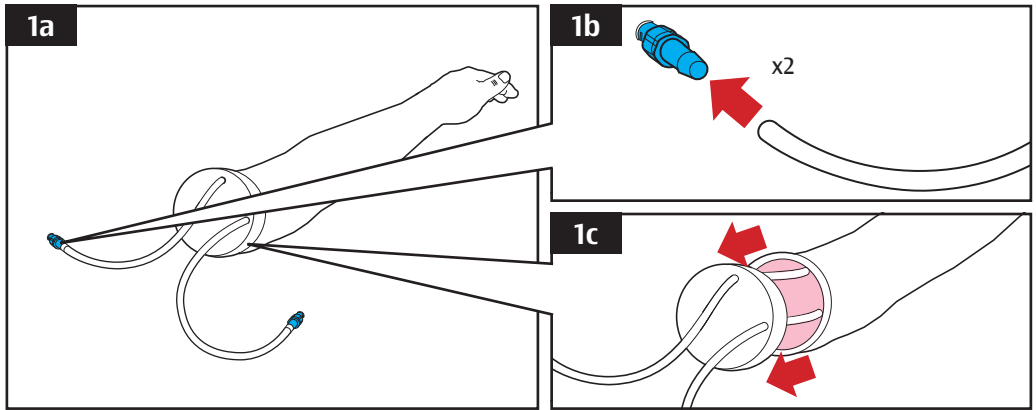

Remove the Old Skin



The veins in this arm contain natural latex which may cause an allergic reaction to some individuals. If a reaction occurs, discontinue use immediately and seek medical advice.

1. Remove the Old Skin and Vein System

1a

Detach the white end cap from the shoulder of the arm and pull off from the two veins completely.

1b

Remove the two blue vein connectors from each arm vein.
Keep these safely for re-fitting onto the new vein set later.

1c

Detach the white end cap from the shoulder of the arm and pull off from the two veins completely.

1d

Pull the old arm skin off the inner arm core and throw away.

Identify the Core

Depending on which version of the AR251 core you have, preparation for the new skin and vein set **varies slightly**.

Identify which arm core you have after removing the skin by looking at the back of the hand on the core (note that the core colour may vary also):

i

For arm core hands with fingers go to **Step 3.1a, Page 7**

ii

For arm core hands with a single vein loop go to **Step 3.2a, Page 9**

iii

For arm cores with two vein loops go to **Step 3.3a, Page 11**

Removing the Fingers (for Arm Cores with Fingers)

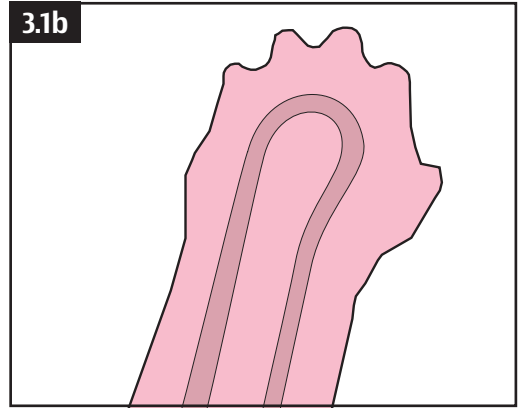
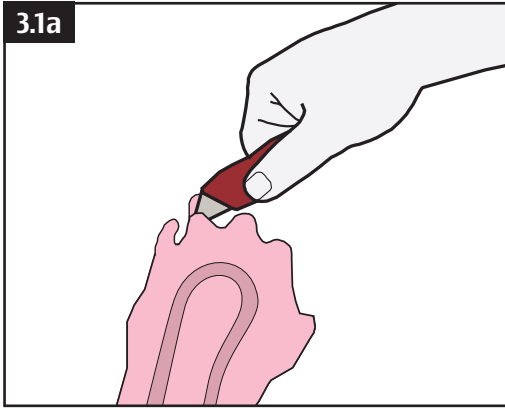

Remove the Old Vein System and Cut off the Fingers

i

This step is for arm core hands with fingers

3.1a

Remove the old vein system from the core by carefully removing it from the channel in the arm core. Using a sharp knife or scissors, cut the fingers off close to the knuckles of the hand.



The new skin supplied in this kit now has solid fingers already integrated. Before fitting the new skin the fingers from the core will need to be removed.

3.1b

With the fingers removed, the arm core is now ready for the new vein set to be installed. Go to **Step 3.2a, next page**.

Inserting the New Vein (for Arm Cores with a Single Vein Loop)

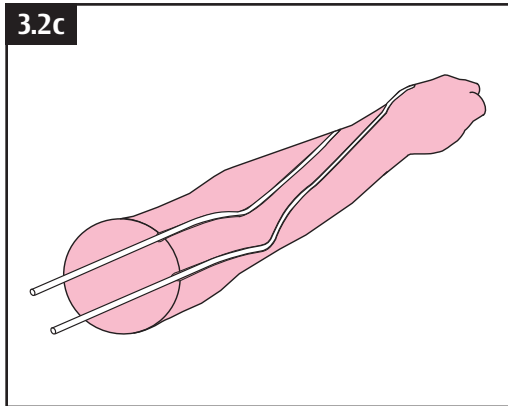
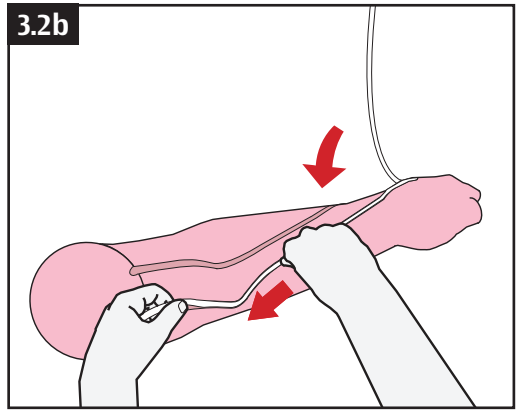
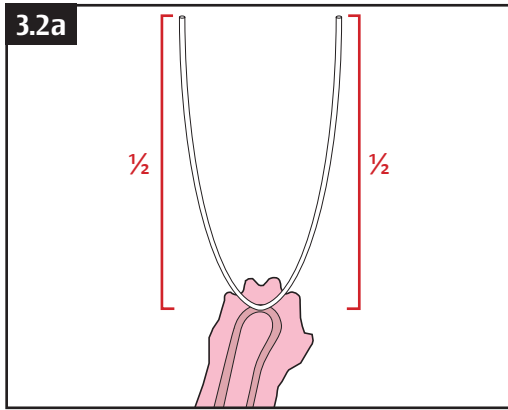

Install the new Vein System

i

This step is for arm core hands with fingers (now removed)

ii

This step is for arm core hands with a single vein loop

3.2a

Remove the old vein system from the core by carefully removing it from the channel in the arm core.

Take the new vein and halve it exactly. Place the halfway point in the loop channel on the back of the hand.

3.2b

Press each half of the new vein into its corresponding channel in the arm core.

3.2c

The arm is now ready for the new skin to be fitted. Please see Step 4, Page 14

Inserting the New Vein (for Arm Cores with Two Vein Loops)

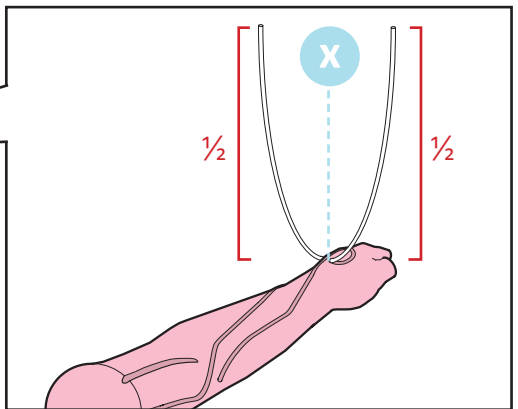
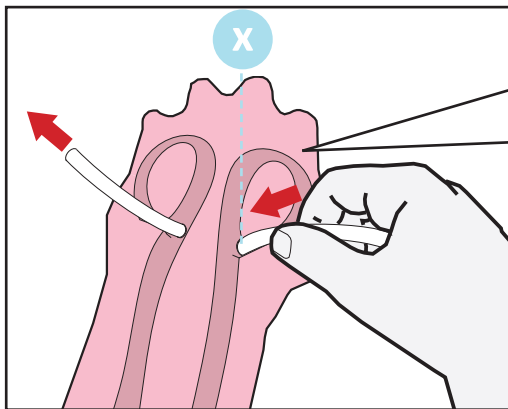
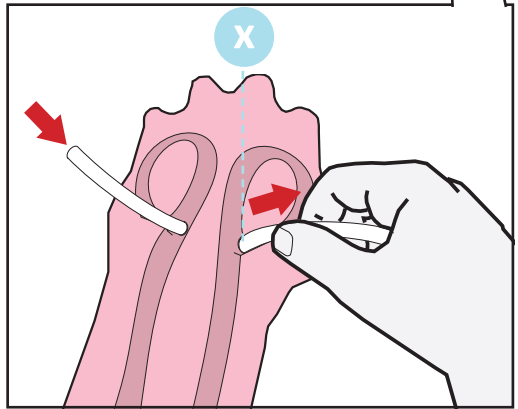
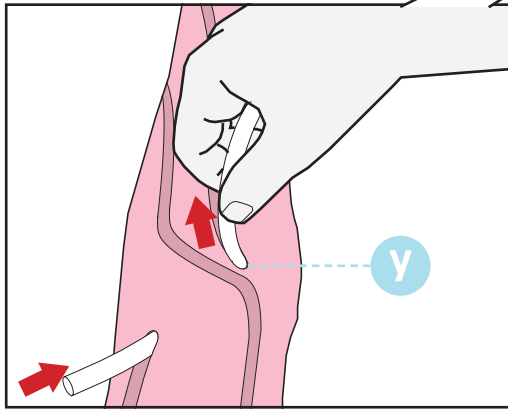
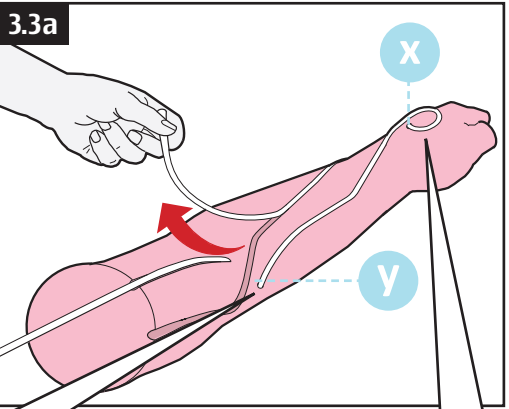

1. Remove the Old Skin and Vein System

iii

This step is for arm cores with two vein loops

3.3a

Remove the old vein system from the core by carefully removing it from the channels in the arm core.

Be sure to remove the veins **carefully** from tunnels **x** and **y** so that the core is not damaged.



Excessive force during vein removal may cause damage to the core.

2. Insert the New Vein System

3.3b

To insert the new vein, first loop it through tunnel **x** in the back of the hand. Pull the vein through so that there are equal halves on each side of the tunnel.

Continues, please see next page...

Inserting the New Vein (for Arm Cores with Two Vein Loops)

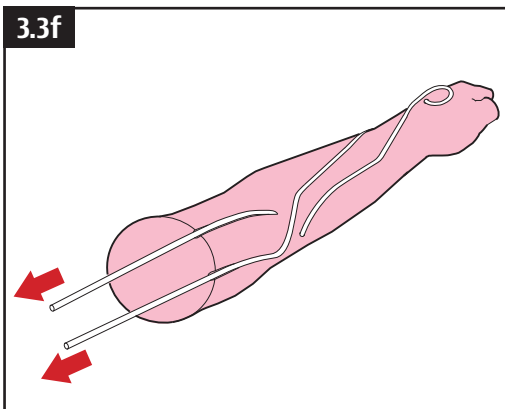
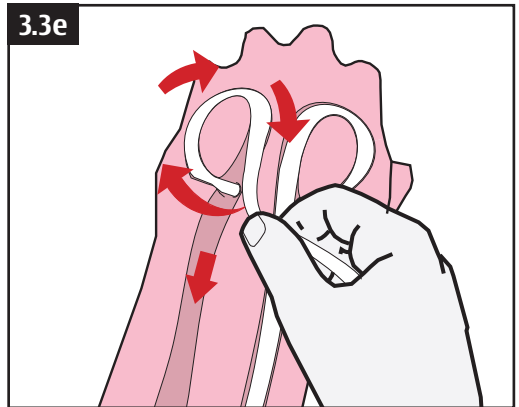
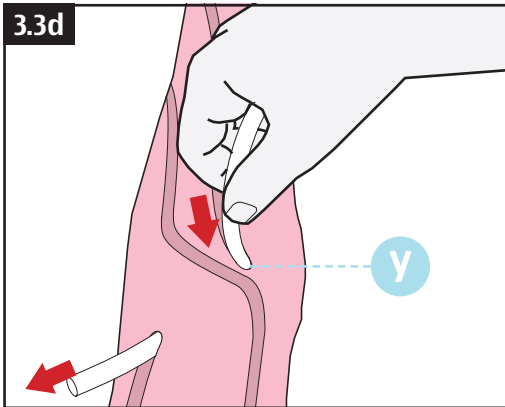
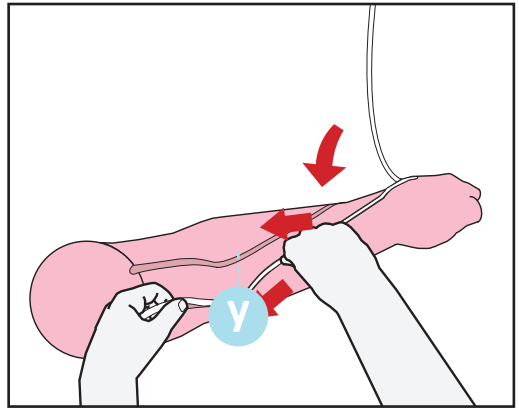
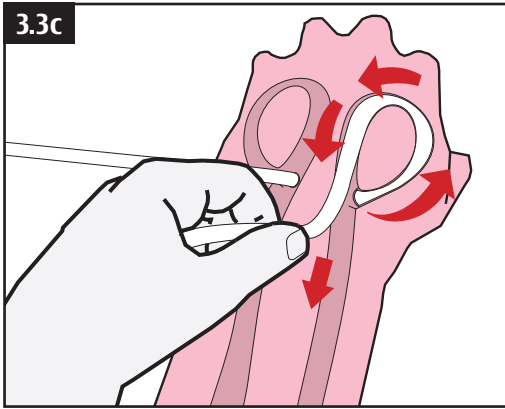

2. Insert the New Vein System (Continued)

3.3c

With the back of the core facing you, loop the first half vein around the right channel in the back of the hand and down the arm to tunnel **Y**

3.3d

Insert the vein through tunnel **Y**

3.3e

Loop the other half of the vein around the left channel in the back of the hand.

3.3f

Insert the rest of the vein system into its corresponding channels in the arm core, keeping the two ends of remaining vein out of the way during installation of the new arm skin.

The arm is now ready for the new skin to be fitted. **Please see Step 4, Page 14**

Installing the New Arm Skin (for All Arm Cores)

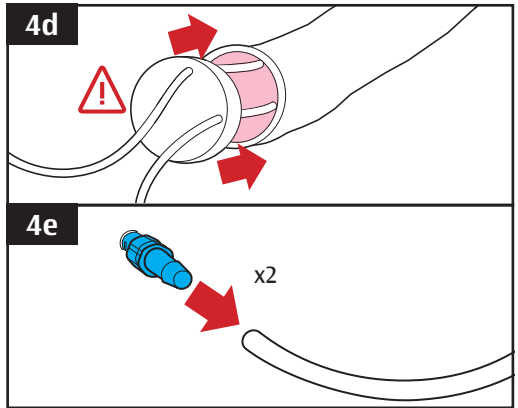
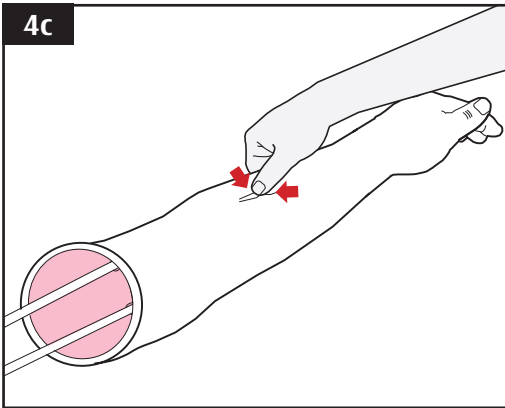
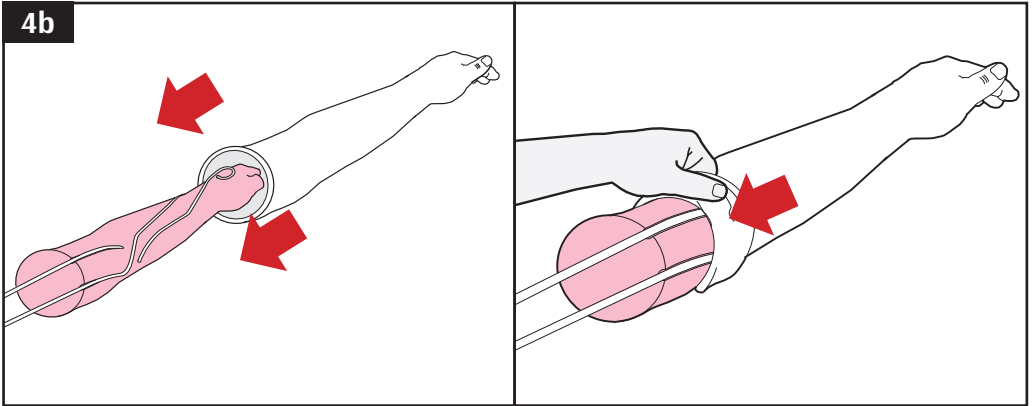
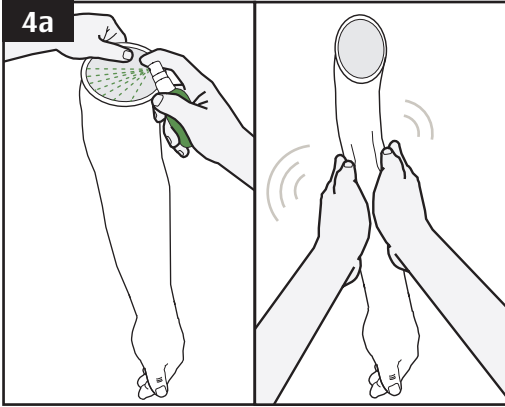

3. Installing the New Arm Skin

i

ii

iii



This step is for all arm cores.

4a

Apply the supplied lubricant liberally down the inside of the new skin and work it down by rubbing sides together.



Please observe the warnings on the lubricant label.

4b

With the end of the arm core facing you, slide the arm core over the hand end of the core, all the way to the shoulder.

4c

Be sure that the new vein system is still in the vein channels in the arm core. If the vein is not in the channel in the core it can be pushed back into the channel through the skin.

4d

Replace the end cap by threading both ends of the vein through the two holes, pushing firmly into place



Ensure that the veins are kink free and pulled fully through the end cap.

4e

Replace both blue vein connectors in each end of the new vein system.

The arm is now ready for use again.

2 Year Guarantee



All products manufactured by Adam,Rouilly are covered by our full 2 Year Guarantee. This guarantee applies to models which have been used correctly and covers durability and functionality.

Adam,Rouilly

As part of our policy of continual product development, the specification of products may alter without prior notice.

Adam,Rouilly has over 100 year's experience in providing quality medical models and simulators.

Should you require any further information please contact our Sales Department who will be pleased to help with your enquiry.

Adam,Rouilly Limited
Castle Road
Eurolink Business Park
Sittingbourne
Kent
United Kingdom
ME10 3AG

T: +44(0)1795 471378
F: +44(0)1795 479787
E: sales@adam-rouilly.co.uk
www.adam-rouilly.co.uk